

# JET

## SELF-PRIMING PUMPS

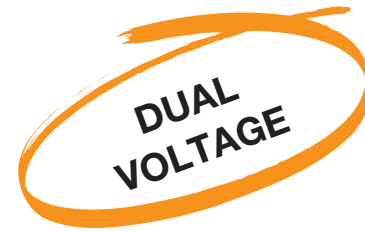

**JET 75**

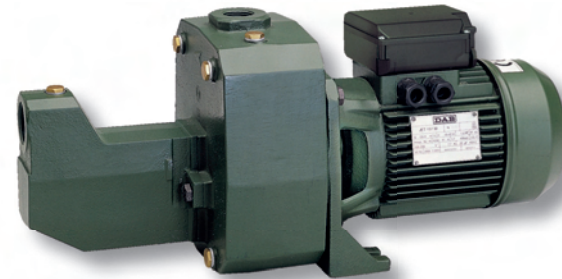

**JET 200**



### GENERAL DATA

#### Applications

Self-priming pumps with excellent suction capacity, allows the passage air bubbles, small particles and sand in the water. Ideal applications are domestic installations, small scale agriculture and gardening. Also suitable for small scale industrial applications and other operations where self-priming is necessary.

#### Construction features of the pump

Cast iron pump body and motor support.  
Technopolymer Impeller, Diffuser, Venturi Tube and Sand Guard.  
Stainless steel pressure discs.  
Carbon/ceramic mechanical seal.

#### Construction features of the motor

Capacitor - Start TEFC.  
Rotor mounted on oversized greased sealed-for-life ball bearings to ensure silent running and long life.  
Built-in thermal and current overload protection.  
Manufactured according to CAN/CSA - C22.2 N° 100-95 / N° 77-95.  
Motor protection: build according to NEMA 4 (IP 44)  
Terminal box protection: build according to NEMA 4x (IP 55)  
Insulation class: F  
Standard voltage: 115 V / 230 V (Jet 75-100-100.1)  
230 V (Jet 150-200-200.1-250)

# JET

## SELF-PRIMING PUMPS



### Technical Data

N.	DESCRIPTIONS*	MATERIALS
1	PUMP BODY	CAST IRON 200 UNI ISO 185
3	SUPPORT	CAST IRON 200 UNI ISO 185 DIE-CAST ALUMINIUM
4	IMPELLER	TECHNOPOLYMER A
7	SHAFT WITH ROTOR	STAINLESS STEEL AISI 416 X12 CrS13 UNI 6900/71
16	MECHANICAL SEAL	CARBON / CERAMIC
28	OR GASKET	NBR RUBBER
160	NOZZLE-VENTURI DIFFUSER IMPELLER	TECHNOPOLYMER A

\* In contact with the liquid.

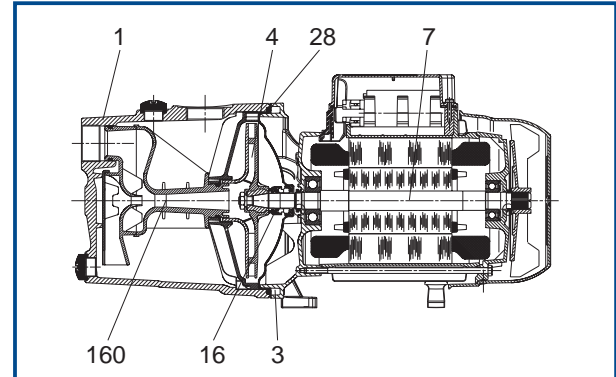

- Operating range: from 2.64 to 50 US G.P.M. (0.6 to 10.5 m<sup>3</sup>/h)  
with heads to 176.5 feet (53.8 metres)
- Liquid quality requirements: clean, free from solids or abrasive substances, non viscous,  
non aggressive, non crystallized, chemically neutral,  
close to the characteristics of water.
- pH level: 6 - 9
- Liquid temperature range: 32°F to 104°F
- Maximum ambient temperature: 104°F
- Maximum suction depth: 26 feet
- Maximum operating pressure: JET 75, JET 100, JET 100.1: 87 PSI (600 kPa)  
JET 150, JET 200, JET 200.1, JET 250: 116 PSI (800 kPa)
- Special applications on request: Other voltages and/or frequencies

# JET SELF-PRIMING PUMPS



## SHALLOW WELL PERFORMANCE CHART

**3400 R.P.M.**

MODEL	HP	DEPTH TO WATER	DISCHARGE PRESSURE (PSI)											SHUT-OFF (PSI)	
			15	20	25	30	35	40	45	50	55	60	65		
			CAPACITY (GPM)*												
JET 50	1/2	5	22,1	22,1	21,5										24,3
		10	19,9	19,8	19,7										26,0
		15	17,4	17,4	17,3	17,1									28,6
		20		15,2	15,2	15,1									30,8
		25	12,1	12,1	12,0	12,0	11,8								34,7
JET 75	3/4	5	22,1	22,1	21,5										24,3
		10	19,9	19,8	19,7									26,0	
		15	17,4	17,4	17,3	17,1								28,6	
		20		15,2	15,2	15,1								30,8	
		25	12,1	12,1	12,0	12,0	11,8							34,7	
JET 100	1	5	21,8	21,8	21,6	21,5	21,3								36,9
		10	19,2	20,1	19,8	19,8	19,5	19,3							38,6
		15	17,6	17,5	17,4	17,3	17,1	17,0							42,1
		20		15,1	14,9	14,9	14,8	14,5	14,4						45,1
		25		12,0	11,8	11,8	11,7	11,6	11,6	11,4					50,3
JET 100.1	1	5				14,5	14,4	14,3	14,2						46,9
		10					13,1	12,8	12,7	12,4				50,3	
		15						11,8	11,6	11,4	10,9			53,4	
		20							9,9	9,8	9,7	9,4		56,9	
		25								7,9	7,8	7,7	7,3	62,9	
JET 150	1 1/2	5		21,0	20,9	20,7	20,6	20,3	20,2	19,9					40,8
		10		19,0	18,8	18,5	18,2	17,9	17,8	17,5	17,3				44,3
		15			15,7	15,5	15,4	15,2	15,1	15,0	14,8	14,5			50,3
		20				13,3	13,1	12,9	12,7	12,5	12,4	12,1	11,9		55,1
		25						9,7	9,5	9,3	9,1	8,9	8,6	8,5	63,4
JET 200	2	5		31,8	31,6	31,2	30,8	30,5	30,1	29,1					30,8
		10		28,0	27,7	27,6	27,2	26,9	26,7	26,0	25,1				34,7
		15		23,6	23,3	23,2	23,1	22,8	22,5	22,3	22,1	20,9			39,1
		20			20,2	19,9	19,8	19,7	19,4	19,3	19,0	18,5	17,3		43,0
		25					14,3	14,2	14,1	13,8	13,7	13,4	13,2		48,2
JET 200.1	2	5	48,5	47,2	45,8	43,9									50,3
		10	43,6	42,9	41,9	40,6	38,3								53,4
		15		36,0	34,8	33,6	32,3	31,0							59,5
		20		30,1	29,3	28,3	27,2	25,9							65,1
		25		22,0	20,9	20,3	19,6	18,8							74,2
JET 250	2 1/2	5		49,5	49,3	48,9	47,9	46,8							52,1
		10		46,0	45,4	45,0	44,5	43,6	42,0						56,4
		15		37,1	36,8	36,5	36,1	35,5	34,7	33,5					61,2
		20		32,1	31,8	31,6	31,2	30,6	30,4	29,3	25,9				66,0
		25		20,9	20,7	20,6	20,4	20,0	19,5	18,8	18,0	16,5	13,8		73,8

\* Capacities given are for near sea level installations.

# JET 50

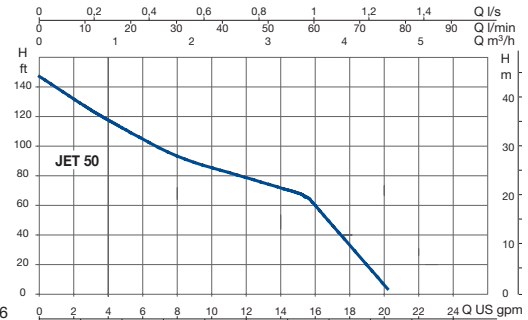
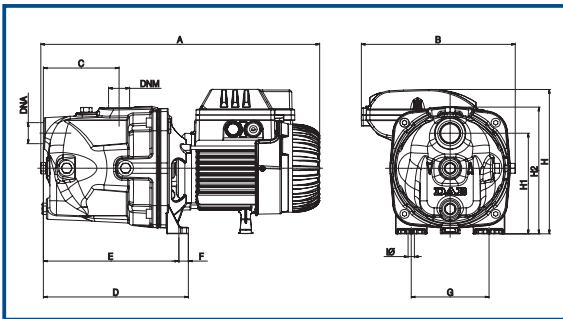

Curve tolerance according to ISO 9906

MODEL	DNA	DNM	DIMENSIONS (inches)									PACKAGING DIMENSIONS			SHIP VOL (Cu Ft)	WEIGHT Lbs
			A	B	C	E	F	G	I	H	H1	L/A	L/B	H		
JET 50	1" NPT	1" NPT	15.67	8.66	4.25	7.56	0.55	4.37	9.00	8.11	5.67	18.9	9.4	9.4	0.99	26.24

MODEL	VOLTAGE 60 Hz-1 Ph	HP	kW	AMPERE	SERVICE FACTOR	RPM	G.P.M.	Ft
JET 50	115-230 V	1/2	0.5	8-4	1.6	3400	2.6 - 15.8	124 - 64

# JET 75

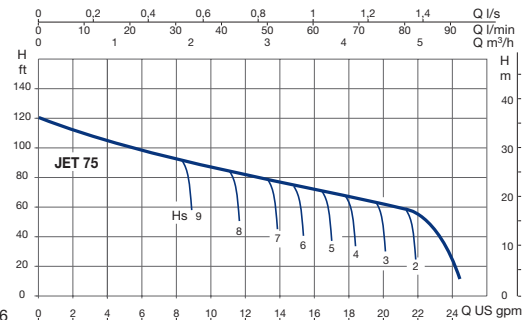
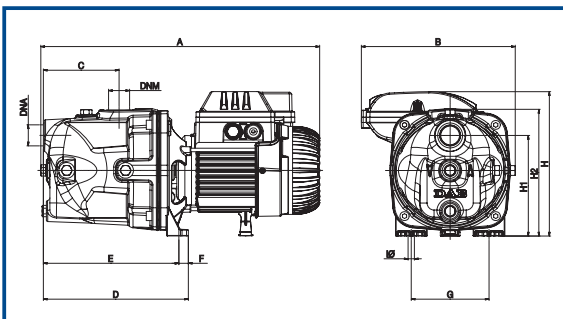

Curve tolerance according to ISO 9906

MODEL	DNA	DNM	DIMENSIONS (inches)									PACKAGING DIMENSIONS			SHIP VOL (Cu Ft)	WEIGHT Lbs
			A	B	C	E	F	G	I	H	H1	L/A	L/B	H		
JET 75	1" NPT	1" NPT	15.67	8.66	4.25	7.56	0.55	4.37	9.00	8.11	5.67	18.9	9.4	9.4	0.99	26.24

MODEL	VOLTAGE 60 Hz-1 Ph	HP	kW	AMPERE	SERVICE FACTOR	RPM	G.P.M.	Ft
JET 75	115-230 V	3/4	0.75	9.6-4.8	1.4	3400	1.5 - 22	121 - 55

# JET 100

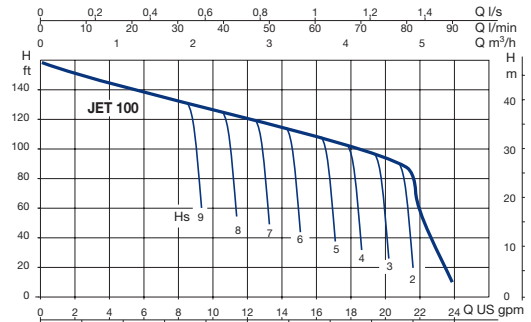
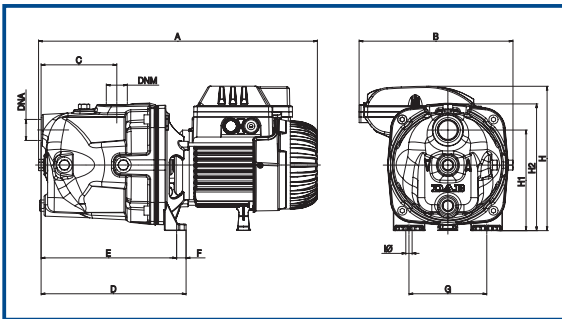

Curve tolerance according to ISO 9906

MODEL	DNA	DNM	DIMENSIONS (inches)									PACKAGING DIMENSIONS			SHIP VOL (Cu Ft)	WEIGHT Lbs
			A	B	C	E	F	G	I	H	H1	L/A	L/B	H		
JET 100	1" NPT	1" NPT	16.46	8.66	4.25	7.56	0.55	4.37	9.00	8.50	5.67	18.9	9.4	9.4	0.99	30.20

MODEL	VOLTAGE 60 Hz-1 Ph	HP	kW	AMPERE	SERVICE FACTOR	RPM	G.P.M.	Ft
JET 100	115-230 V	1 1/2	1	14.5 - 7.6	1.35	3400	1.5 - 21.5	154 - 82

# JET 100.1

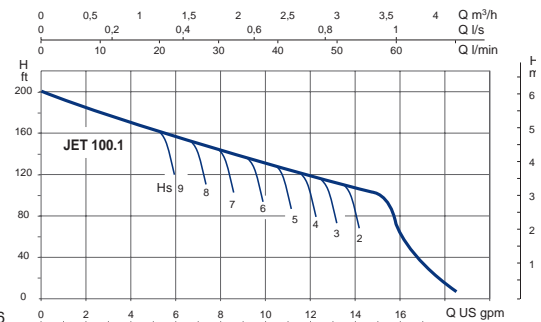
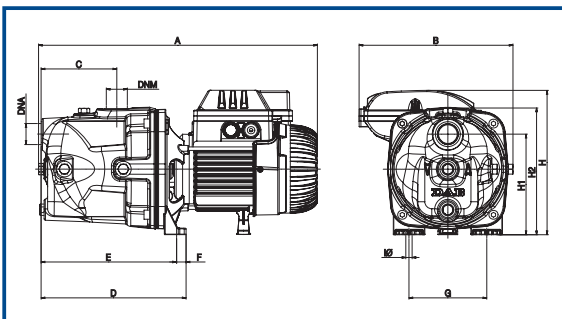

Curve tolerance according to ISO 9906

MODEL	DNA	DNM	DIMENSIONS (inches)									PACKAGING DIMENSIONS			SHIP VOL (Cu Ft)	WEIGHT Lbs
			A	B	C	E	F	G	I	H	H1	L/A	L/B	H		
JET 100.1	1" NPT	1" NPT	16.46	8.66	4.25	7.56	0.55	4.37	9.00	8.50	5.67	18.9	9.4	9.4	0.99	30.20

MODEL	VOLTAGE 60 Hz-1 Ph	HP	kW	AMPERE	SERVICE FACTOR	RPM	G.P.M.	Ft
JET 100.1	115-230 V	1 1/2	1	13.9 - 7.2	1,35	3400	0.8 - 15.7	112 - 118

# JET 150

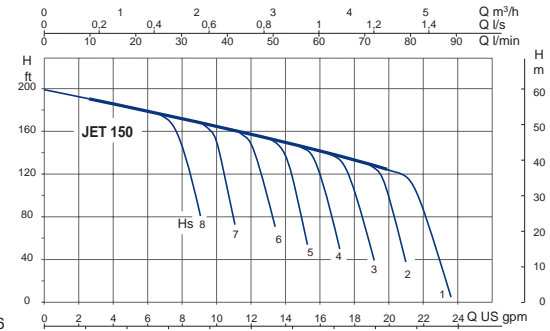
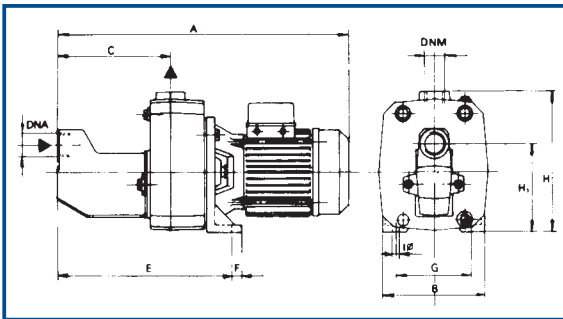

Curve tolerance according to ISO 9906

MODEL	DNA	DNM	DIMENSIONS (inches)									PACKAGING DIMENSIONS			SHIP VOL (Cu Ft)	WEIGHT Lbs
			A	B	C	E	F	G	I	H	H1	L/A	L/B	H		
JET 150	1 1/4" NPT	1" NPT	22.2	8.3	8.7	13.8	0.8	5.7	0.4	6.0	10.0	24.1	9.8	11.0	1.48	69.4

MODEL	VOLTAGE 60 Hz-1 Ph	HP	kW	AMPERE	SERVICE FACTOR	RPM	G.P.M.	Ft
JET 150	115-230 V	1 1/2	1.1	7.7	1.3	3400	2.6 - 20	190-125

# JET 200

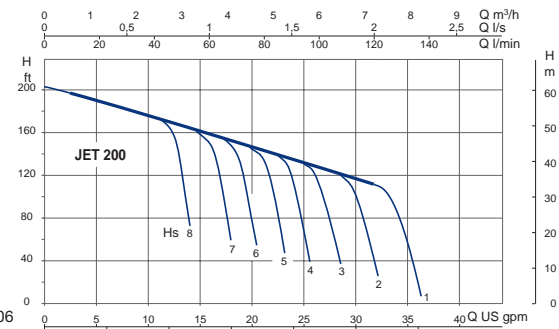
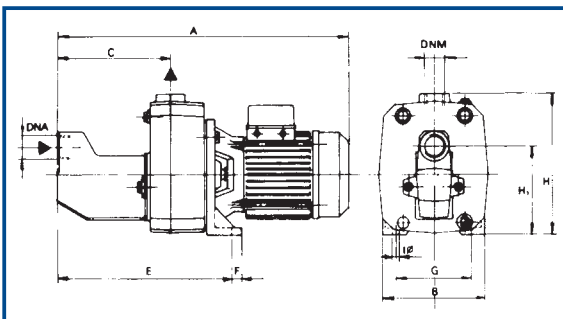

Curve tolerance according to ISO 9906

MODEL	DNA	DNM	DIMENSIONS (inches)									PACKAGING DIMENSIONS			SHIP VOL (Cu Ft)	WEIGHT Lbs
			A	B	C	E	F	G	I	H	H1	L/A	L/B	H		
JET 200	1 1/4" NPT	1" NPT	25.6	8.3	8.7	13.8	0.78	5.7	0.43	6.2	10.0	25.9	9.8	11.0	1.59	77.09

MODEL	VOLTAGE 60 Hz-1 Ph	HP	kW	AMPERE	SERVICE FACTOR	RPM	G.P.M.	Ft
JET 200	230 V	2	1.9	10.5	1.2	3400	2.6 - 30.8	197-111

## JET 200.1

Curve tolerance according to ISO 9906

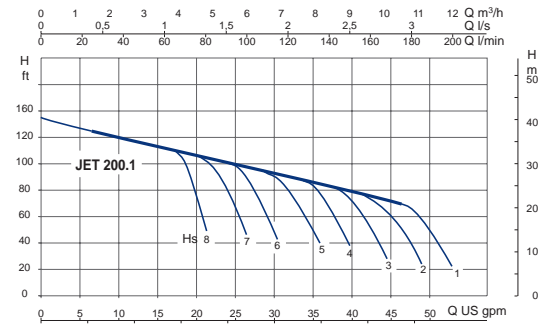
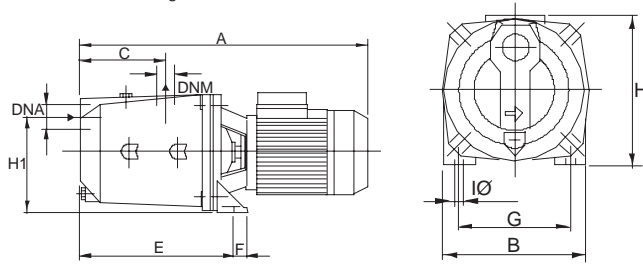

MODEL	DNA	DNM	DIMENSIONS (inches)								PACKAGING DIMENSIONS			SHIP VOL (Cu Ft)	WEIGHT Lbs	
			A	B	C	E	F	G	I	H	H1	L/A	L/B			H
JET 200.1	1 1/2" NPT	1 1/4" NPT	20.51	5.94	11.10	0.79	6.30	0.43	/	8.94	6.89	24.1	9.8	11.0	1.48	59.52

MODEL	VOLTAGE 60 Hz-1 Ph	HP	kW	AMPERE	SERVICE FACTOR	RPM	G.P.M.	Ft
JET 200.1	230 V	2	1.5	9.8	1.25	3400	4.8 - 48	123-62

Curve tolerance according to ISO 9906

## JET 250

Curve tolerance according to ISO 9906

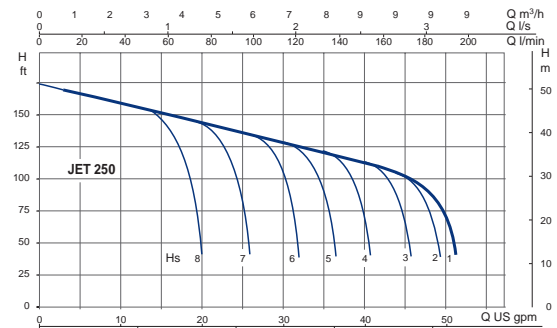
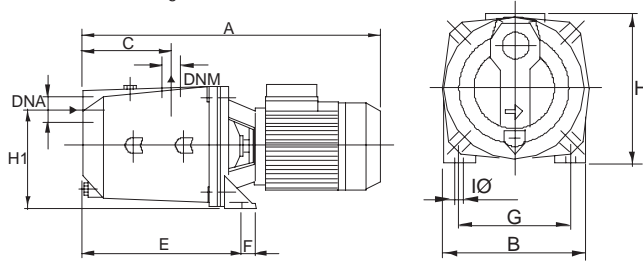

MODEL	DNA	DNM	DIMENSIONS (inches)								PACKAGING DIMENSIONS			SHIP VOL (Cu Ft)	WEIGHT Lbs	
			A	B	C	E	F	G	I	H	H1	L/A	L/B			H
JET 250	1 1/2" NPT	1 1/4" NPT	23.43	5.94	11.10	0.79	6.30	0.43	/	9.25	6.89	25.9	9.8	11.0	1.59	69.45

MODEL	VOLTAGE 60 Hz-1 Ph	HP	kW	AMPERE	SERVICE FACTOR	RPM	G.P.M.	Ft
JET 250	230 V	2 1/2	2.2	12.1	1.15	3400	4.8 - 45	160-100